

Wall box, for flush mounting

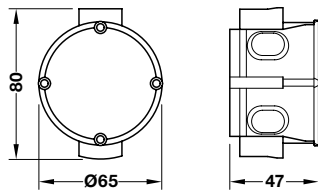

- > Dimensions according to DIN standard
- > Black plastic
- > Order qty: 1 pc



Depth	Cat. No.
47 mm	917.91.029

Wall box, for cavity wall mounting

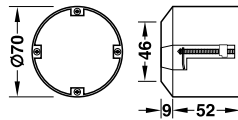

- > 61 mm depth, for Ø 68 mm milled hole
- > For standard combination distances of 71 mm
- > For plate thickness 7-35 mm
- > With retaining edge
- > Dimensions according to DIN standard
- > Orange plastic
- > Order qty: 1 pc

Depth	Cat. No.
61 mm	917.91.012

Small distributor box

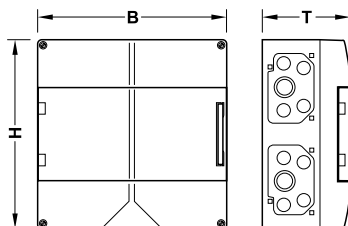

- > Area of application: For installation of safety transformer, automatic circuit breaker, installation control relay and electronic control unit module
- > Version: With top hat rail, IP 65 with door, IP 30 without door
- > Grey plastic housing
- > Order qty: 1 pc



Item	Size (B x T x H)	Cat. No.
Degree of protection - IP65		
14 joint units (single row)	300 x 142 x 300 mm	910.51.988
28 joint units (double row)	300 x 142 x 450 mm	910.51.989
Degree of protection - IP30		
12 joint units (single row)	305 x 99 x 250 mm	910.51.986
24 joint units (double row)	305 x 99 x 375 mm	910.51.987



Only IP65 versions are suitable for use with WTC 200

Top hat rail

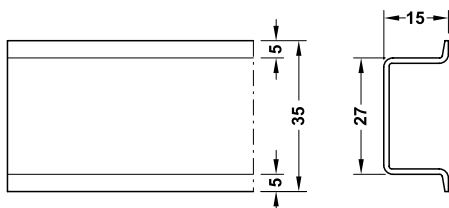

- > Standard: In compliance with EN 50 022
- > Yellow chromated steel
- > 2000 mm length
- > Order qty: 1 pc

Top hat rail	Cat. No.
	917.91.024



Most of the products you will find in this catalogue are available within 24 hours. However, to be able to offer the breadth of range in our collection, a small number of products have a longer lead time that is typically around 14 days. Please call 0800 171 2909 for an accurate delivery date when you see this symbol.

PAGE AMENDED
23.07.21/1