

LIFT-OFF HINGE (WELD-ON)

STAINLESS 304 STEEL

HNH



Right-Hand Opening

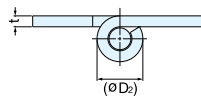
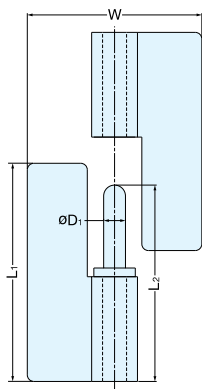

- Weld-on type lift-off hinge.
- Left and Right handed available.

Material	Finish
304 Stainless Steel	Mirror

Item No.		L ₁	L ₂	W	D ₁	(D ₂)	t	Weight (g)	Box (pcs)	Carton (pcs)
Left	Right									
HNH- 50CL	HNH- 50CR	50 (1-31/32")	45	40 (1-37/64")	5	10.5	2.5	62	30	240
HNH- 65CL	HNH- 65CR	65 (2-9/16")	60	50 (1-31/32")				95	20	160
HNH- 75CL	HNH- 75CR	75 (2-61/64")	70	70 (2-3/4")	6	12	3	180	10	80
HNH-100CL	HNH-100CR	100 (3-15/16")	90	82 (3-15/64")	8	16	4	335	5	40

LIFT-OFF HINGE (WELD-ON)

STAINLESS 304 STEEL

S-6166-2



Right



Left

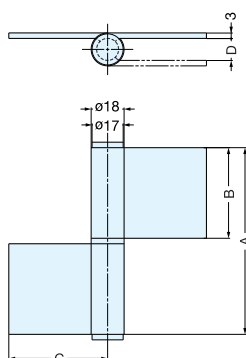

- Weld-on type stainless steel lift-off hinge.
- Left and Right handed available.
- Door weight: Max. 40kg/pair (88lbs/pair)

Material	Finish
304 Stainless Steel	Satin

Item No.		A	B	C	D	Weight (g)	Box (pcs)	Carton (pcs)
Left	Right							
S-6166-2-L	S-6166-2-R	102 (4-1/64")	49.5 (1-61/64")	55 (2-5/32")	12 (15/32")	300	12	60

LIFT-OFF HINGE (WELD-ON)

STAINLESS 304 STEEL

S-6166-6



Right



Left

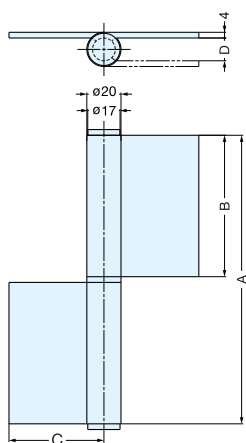

- Weld-on type stainless steel lift-off hinge.
- Left and Right handed available.
- Door weight: Max. 90kg/pair (198lbs/pair)

Material	Finish
304 Stainless Steel	Satin

Item No.		A	B	C	D	Weight (g)	Box (pcs)	Carton (pcs)
Left	Right							
S-6166-6-L	S-6166-6-R	152 (5-63/64")	74.5 (2-15/16")	55 (2-5/32")	12 (15/32")	570	8	40