

LID STAY (W/LOCK)

TEST METHOD

LOAD CAPACITY
30 kg
66 lbs

NO SCREW

STAINLESS 304 STEEL

LSP



- Mechanically locks lid when fully opened.
- Ideal for vibration or shock application.
- Pull the locking knob to release lock.
- Non-Handed
- Only one stay per lid required.

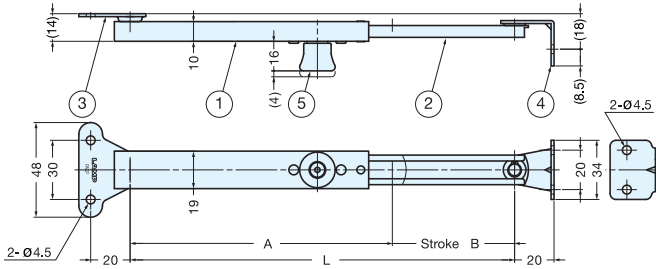

LSP-195B

LSP-270B

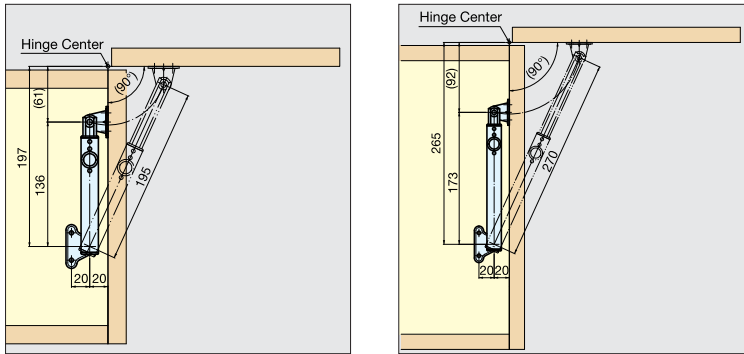

*Lid stay must be installed parallel to the sidewall.

| No. | Part Name | Material | Finish/Color |
|-----|--------------|---------------------|--------------|
| ① | Case | 304 Stainless Steel | Satin |
| ② | Arm | | |
| ③ | Case Bracket | | |
| ④ | Arm Bracket | | |
| ⑤ | Locking knob | ABS | Dark Grey |

| Item No. | L | A | B | Load Capacity (kg) | Weight (g) | Box (pcs) | Carton (pcs) |
|----------|------------------|------------------|------------------|--------------------|------------|-----------|--------------|
| LSP-195B | 195 (7-43/64") | 133 (5-15/64") | 62 (2-7/16") | 30 (66 lbs) | 126 | 6 | 60 |
| LSP-270B | 270 (10-5/8") | 170 (6-11/16") | 100 (3-15/16") | 30 (66 lbs) | 147 | | |

CLEAN LID STAY

LOAD CAPACITY
15 kg
33 lbs

NO SCREW

STAINLESS 304 STEEL

LB-CV215A



PAT

- Holds lid or panel in fully opened position.
- Plastic bushing and end cap to minimize particles.
- No metal-to-metal contact.
- Ideal for cleanroom, semiconductor and food industry application.
- Non-handed.
- Can be used singly or in pairs.

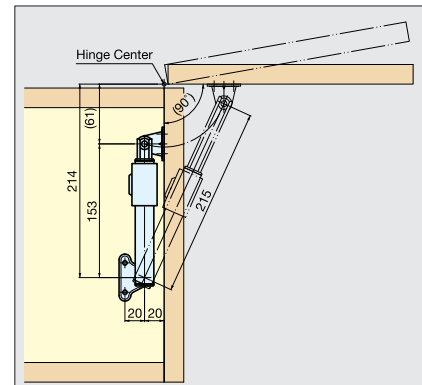
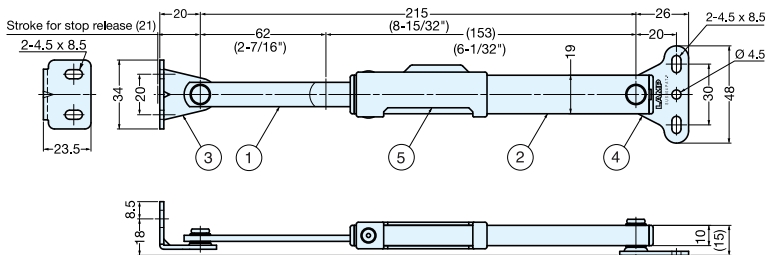

*Lid stay must be installed parallel to the sidewall.

| Item No. | Load Capacity (kg) | Weight (g) | Box (pcs) | Carton (pcs) |
|-----------|--------------------|------------|-----------|--------------|
| LB-CV215A | 15 (33 lbs) | - | 10 | 100 |

| Material | Finish/Color |
|---------------------|--------------|
| 304 Stainless Steel | Plain |
| ABS | White |