

GRASS TIOMOS M0

9

Furniture Hinges and Flap Fittings: Hinges



- > For door thicknesses of 6-10 mm
- > Opening angle 125°
- > No cup hole necessary
- > For door overlays up to 25 mm
- > 3-dimensional adjustment with appropriate mounting plate
- > Zero protrusion up to 14 mm overlay

Screwing position

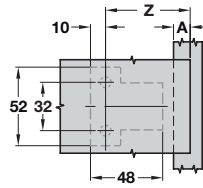

	Mounting plate height 0		
Z	A+41		
A	Max. 25		
	Screwing dimension (Z)		

Overlay

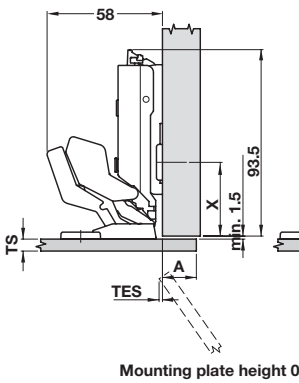

Half overlay

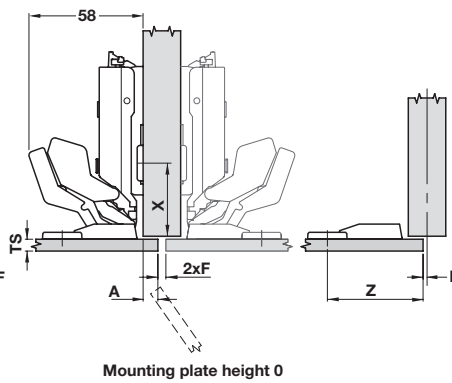

Inset

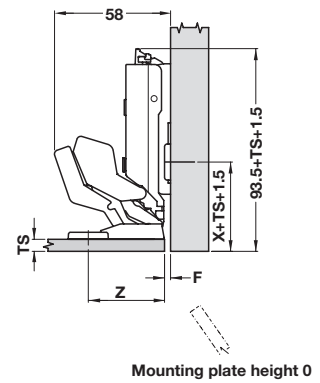

Minimum gap/minimum reveal

Values for 0 mm mounting plate height

Screwing dim. Z	38	39	47	49	51	53	55
Door protrusion TES	0	0	0	0	0	0	0
Door overlay A	-3	-2	6	8	10	12	14
Door thickness TS							
Min. reveal F / Gap S	F S	F S	F S	F S	F S	F S	F S
6-10 mm	2 1.5	2 1.5	2 1.5	2 1.5	2 1.5	2 1.5	2 1.5

Minimum gap/minimum reveal

Values for 0 mm mounting plate height

Screwing dim. Z	56	58	60	61	63	64	66
Door protrusion TES	0.5	1.5	3	3.4	0	0	0
Door overlay A	15	17	19	20	22*	23*	25*
Door thickness TS							
Min. reveal F / Gap S	F S	F S	F S	F S	F S	F S	F S
6-10 mm	2 1.5	2 1.5	2 1.5	2 1.5	2 2.5	2 3	2 4

* Door thickness A = 22-25 mm only with opening angle reduction clip



Trial fitting is recommended for all door thicknesses

Grass Tiomos M0

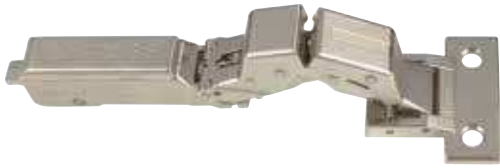

- > Order fixing screws separately, shown below
- > Order qty: 1 pc



Version	Cat. No.
Integrated damper	348.27.801
Without integrated damper	348.27.601
Tipmatic Plus	348.23.101
Tipmatic	348.27.401



Ordering information for Tiomos Tipmatic Plus and Tipmatic is shown on pages **60-61**

Grass countersunk screws for Tiomos M0



348.40.040 - M5 x 6 mm countersunk screw



348.40.041 - M4 x 8 mm countersunk screw, sleeve and hex key set

- > For fixing Tiomos M0 hinges
- > M5 x 6 mm countersunk screw:
For minimum door thickness 6 mm
For aluminium, HPL, mineral composite
Order qty: Multiples of 50 pcs
- > M4 x 8 mm countersunk screw set:
Includes M4 x 5.5 mm sleeve and internal hex key
For minimum door thickness 8 mm
For chipboard, MDF, mineral composite, HPL
Order qty: See table below: Multiples of 50 pcs or 1 set (100x screws, 100x sleeves, 1x hex key)



Item	Cat. No.	Order qty
M5 x 6 mm screw	348.40.040	50 pcs
M4 x 8 mm screw set	348.40.041	1 set

Grass Tiomos opening angle restraint

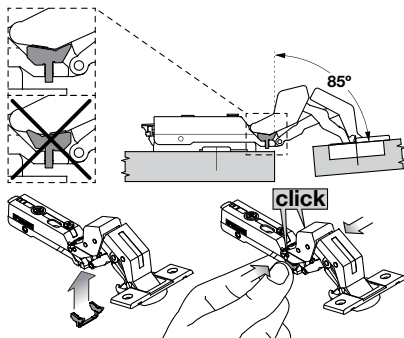

- > Prevents the door from butting against front panels or walls with corner mounting by reducing opening angle to 90°
- > For use with TIOMOS M9, M0 and Mirro 125° hinges
- > Black plastic
- > Order qty: 1 pc



Opening angle	Cat. No.
90°	348.40.012

YOU ALSO NEED:

MOUNTING PLATES
Pages 66-68

FIXING SCREWS
Section 13 page 88

OPTIONAL ACCESSORIES
Pages 73-74, 109-121

Grass Tiomos inline mounting plate

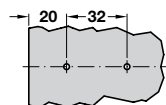
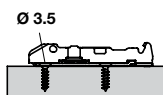

- > For TIOMOS click on fixing hinges only
- > Varianta screw fixing
- > Two part plate with ± 2 mm height adjustment via worm screw
- > Nickel-plated steel
- > Order fixing screws separately
- > Order qty: 1 pc



Height	Varianta screw
0 mm	348.38.501



A wider range of mounting plates are shown on pages **66-68**

TCH TECHNOLOGY 2018. © Häfele U.K. Ltd 2018. Dimensional data not binding. We reserve the right to alter specifications without notice.

TIOMOS CLICK ON MOUNTING PLATES AND ACCESSORIES



TIOMOS click on fixing hinges are shown on pages **36-63**

9

Furniture Hinges and Flap Fittings: Hinges

Grass Tiomos cruciform mounting plate, 4 point fixing



Nickel-plated

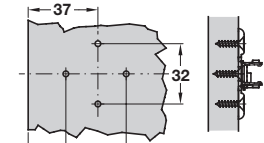

For Hospa screws

- > For TIOMOS click on fixing hinges only
- > Hospa screw fixing or with pre-mounted Euro screws or dowel fixing
- > Two part plate with ± 2 mm height adjustment via worm screw
- > Steel
- > Order fixing screws separately for Hospa screw fixing versions
- > Order qty: 1 pc



Nickel-plated

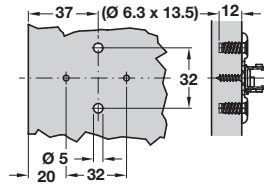

With pre-mounted Euro screws



Anthracite



Nickel-plated

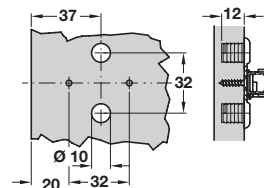

With dowel fixing



Height	Hospa screw	Pre-mounted	Dowel
Nickel-plated finish			
0 mm	348.38.511	348.38.521	348.38.541
2 mm	348.38.512	348.38.522	348.38.542
3 mm	348.38.513	348.38.523	-
Tiomos Night - Anthracite finish			
0 mm	348.38.040	348.38.050	-
2 mm	348.38.042	348.38.052	-

Grass Tiomos inline mounting plate



Nickel-plated

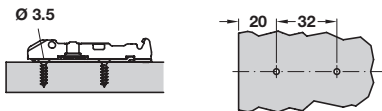

For Varianta

- > For TIOMOS click on fixing hinges only
- > Varianta screw fixing or dowel fixing
- > Two part plate with ± 2 mm height adjustment via worm screw
- > Steel
- > Order fixing screws separately for Varianta screw fixing versions
- > Order qty: 1 pc



Anthracite



Nickel-plated

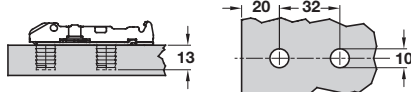

With dowel fixing



Height	Screw fixing	Dowel
Nickel-plated finish		
0 mm	348.38.501	348.38.010
2 mm	348.38.502	348.38.012
3 mm	348.38.503	-
Tiomos Night - Anthracite finish		
0 mm	348.38.030	-
2 mm	348.38.032	-
3 mm	348.38.033	-



Order Varianta screw **013.01.711** separately for screw fixing version to ensure correct fit, shown in **Section 13** on page **22**



Most of the products you will find in this catalogue are available within 24 hours. However, to be able to offer the breadth of range in our collection, a small number of products have a longer lead time that is typically around 14 days. Please call 0800 171 2909 for an accurate delivery date when you see this symbol.

Grass Tiomos cruciform mounting plates, 2 point fixing

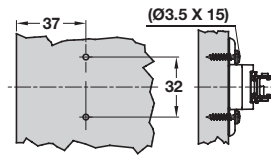
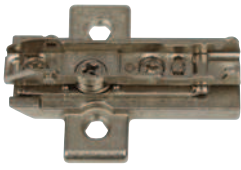

- > For TIOMOS click on fixing hinges only
- > Hospa screw fixing
- > Two part plate with ± 2 mm height adjustment via worm screw
- > Nickel-plated steel
- > Order fixing screws separately
- > Order qty: 1 pc



Height	Hospa screw
6 mm	348.39.511
8 mm	348.39.512
14 mm	348.39.536
19 mm	348.39.519
21 mm	348.39.520

Grass Tiomos inset beaded mounting plate for frame constructions, 3 point fixing

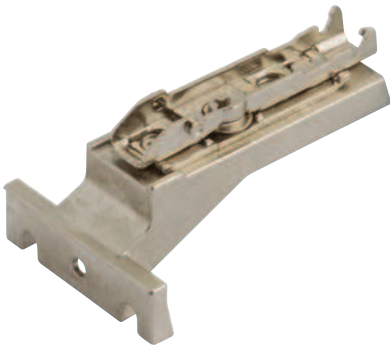

- > For inset doors
- > To be used with TIOMOS half overlay hinges
- > Hospa screw fixing
- > With convenient height adjustment ± 2 mm via worm screw
- > Nickel-plated steel and zinc alloy
- > Order fixing screws separately
- > Order qty: 1 pc

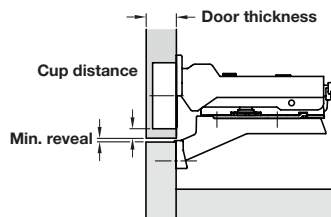
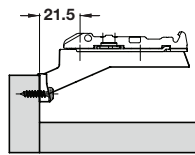
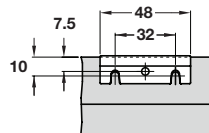

Door thickness mm									
	16	18	19	20	22	24	26	28	
	3	3	3	3	3	3	3	3	4
	4	4	4	4	4	4	4		3
	5	5	5	5	5	5			2
	6	6	6	6					1
Distance to cup mm									Minimum reveal mm



Height	Cat. No.
0 mm	348.38.020

Grass Tiomos ECON cruciform mounting plate, 3 point fixing

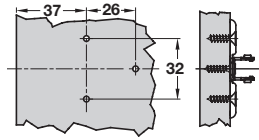

For Hospa screws

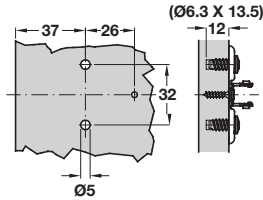

With pre-mounted Euro screws

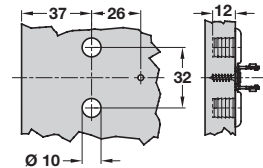

With dowel fixing

- > For TIOMOS click on fixing hinges only
- > Hospa screw fixing or with pre-mounted Euro screws or dowel fixing
- > One part plate with ± 2.5 mm height adjustment by slot
- > Nickel-plated steel
- > Order fixing screws separately for Hospa screw fixing versions
- > Order qty: 1 pc



Height	Hospa screw	Pre-mounted	Dowel
0 mm	348.38.612	348.38.551	348.38.591
2 mm	348.38.613	348.38.552	348.38.592
-2 mm	348.38.560	-	-



TIOMOS click on fixing hinges are shown on pages 36-63

Cover caps

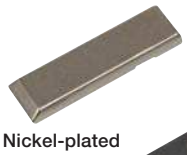

Nickel-plated

Night - Anthracite
For hinge arm

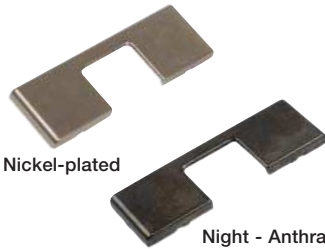

Nickel-plated

Night - Anthracite
For hinge cup

- > Steel
- > Order qty: 1 pc



Suitable for	Hinge arm	Hinge cup
Nickel-plated finish	348.40.000	348.40.001
Night - Anthracite finish	348.40.005	348.40.006

Grass Tiomos cover caps, with Grass logo



- > Suitable for hinge arm
- > With GRASS logo embossed
- > Nickel-plated steel
- > Order qty: 1 pc



Hand	Right	Left
Cat. No.	348.40.003	348.40.004

Grass Tiomos wedge



Wedge +5°

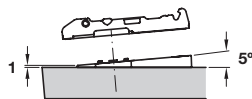

Wedge -5°

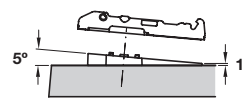

- > Ideal for curved door applications
- > For cruciform mounting plates that require underlaying either +/- 5°
- > For screwing into 32/37 mm series drilled holes
- > Nickel plated zinc alloy
- > *Max. 3 wedges stacked on top of each other
- > Order qty: 1 pc



	Cat. No.
Wedge + 5° *	348.40.020
Wedge - 5°	348.40.021