

GRASS TIOMOS MIRRO FOR GLASS DOORS

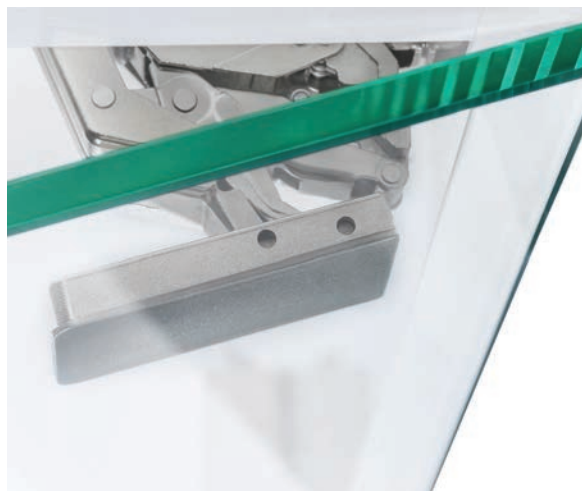

- > For glass thickness 3-8 mm
- > Opening angle 125°
- > 3-dimensional adjustment with appropriate mounting plate
- > Fastening through door-side gluing of a zinc alloy adapter
- > Connection of the hinge to the adapter using a cam
- > Quick final assembly without glass drilling
- > High overlay up to 19 mm

YOU
ALSO
NEED:



MOUNTING PLATES
Pages 66-68



ADAPTER
Page 61

OPTIONAL ACCESSORIES
Pages 73-74, 109-121

Number of hinges

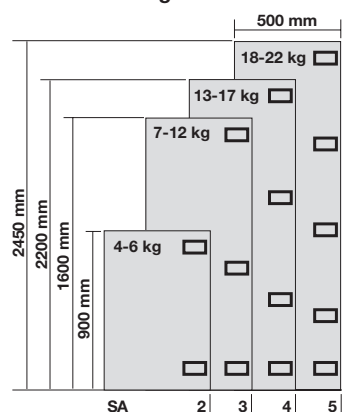

Overlay

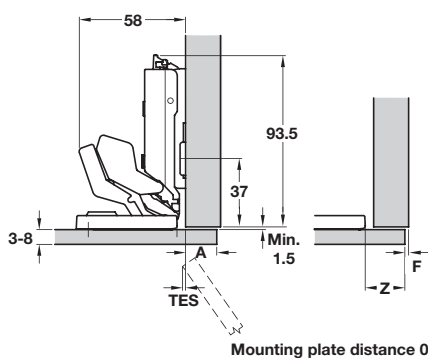

Half overlay

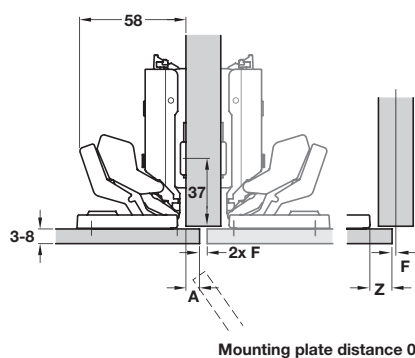

Inset

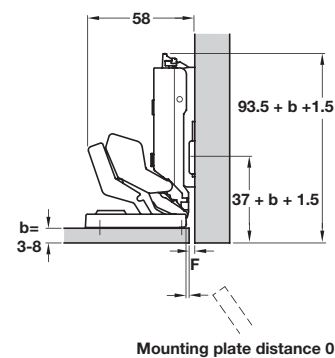

Gluing dimension Z	1.5	2.5	10.5	12.5	14.5	16.5	18.5	19.5	21.5	23.5
Door protrusion TES	0	0	0	0	0	0	0	0.5	1.5	3
Door overlay A	-3	-2	6	8	10	12	14	15	17	19
Min. reveal F / Gap S	F S	F S	F S	F S	F S	F S	F S	F S	F S	F S
Door thickness 3-8	2 1.5	2 1.5	2 1.5	2 1.5	2 1.5	2 1.5	2 1.5	2 1.5	2 1.5	2 1.5



- > Insetting of the door is achieved via a modified mounting plate attachment spacing (X) and a small gluing gap (Z)
- > Attention: With mirror or glass doors all reveals must be at least 1.5 mm (otherwise there is a risk of breakage). The inner door must not touch the rack upon opening
- > **Installation advice:** Please contact your glass or door supplier in respect of glue selection and how to use the glue for fastening of the hinge retainer on mirror or glass doors
- > **Liability claims:** We cannot accept liability either for the glue used or the gluing process nor can we accept any responsibility for claims arising therefrom; we kindly ask for your understanding in this respect

Grass Tiomos Mirro for glass doors



- > Adapter must be ordered separately
- > Order qty: 1 pc



GRASS
25
YEAR
WARRANTY

Version	Cat. No.
Integrated damper	348.41.840
Without integrated damper	348.41.640
Tipmatic Plus	348.41.140
Tipmatic	348.41.440



Ordering information for Tiomos Tipmatic Plus and Tipmatic is shown on pages 60-61

Grass Tiomos opening angle restraint

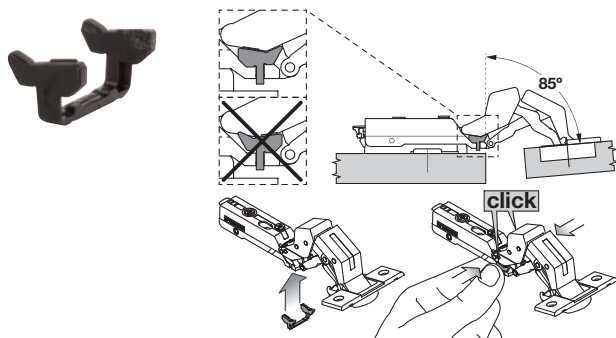

- > Prevents the door from butting against front panels or walls with corner mounting by reducing opening angle to 90°
- > For use with TIOMOS M9, M0 and Mirro 125° hinges
- > Black plastic
- > Order qty: 1 pc

GRASS
25
YEAR
WARRANTY

Opening angle	Cat. No.
90°	348.40.012

Grass Tiomos adapter

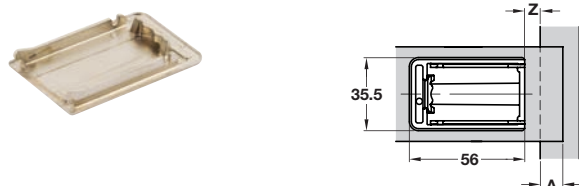

- > For use with Tiomos Mirro, for clear glass
- > Zinc alloy
- > Order qty: 1 pc

GRASS
25
YEAR
WARRANTY

	Cat. No.
Adapter	348.40.074

MultiFix power adhesive, 12 ml



- > For bonding almost any material combinations including metal, most plastics, glass, fibreglass, wood, composites, carbon fibre, brick, concrete, stone and gems
- > 1hr curing time, 3-5 minutes handling strength
- > Low odour
- > Weather resistant
- > 12 ml cartridge
- > Order qty: 1 pc



We recommend using a Isopropyl alcohol wipe to remove any excess adhesive. We would not recommend using Meths or white spirit

Colour	Cat. No.
Blue	003.50.151

Grass Tiomos inline mounting plate

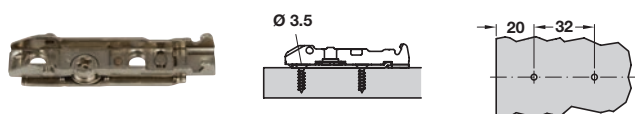

- > For TIOMOS click on fixing hinges only
- > Varianta screw fixing. Order fixing screws separately
- > Two part plate with ± 2 mm height adjustment via worm screw
- > Nickel-plated steel
- > Order qty: 1 pc

BEST
SELLER

GRASS
25
YEAR
WARRANTY

FIXINGS
REQUIRED
VARIANTA
5



A wider range of mounting plates are shown on pages 66-68

Height	Varianta screw
0 mm	348.38.501

TIOMOS CLICK ON MOUNTING PLATES AND ACCESSORIES



TIOMOS click on fixing hinges are shown on pages **36-63**

Grass Tiomos cruciform mounting plate, 4 point fixing



Nickel-plated

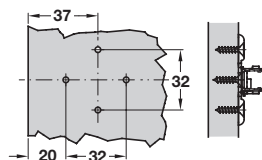

For Hospa screws

- > For TIOMOS click on fixing hinges only
- > Hospa screw fixing or with pre-mounted Euro screws or dowel fixing
- > Two part plate with ± 2 mm height adjustment via worm screw
- > Steel
- > Order fixing screws separately for Hospa screw fixing versions
- > Order qty: 1 pc



Nickel-plated

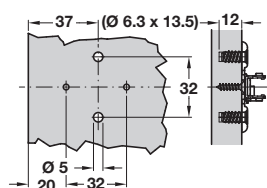

With pre-mounted Euro screws



Anthracite



Nickel-plated

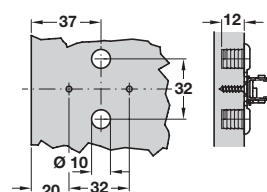

With dowel fixing



Height	Hospa screw	Pre-mounted	Dowel
Nickel-plated finish			
0 mm	348.38.511	348.38.521	348.38.541
2 mm	348.38.512	348.38.522	348.38.542
3 mm	348.38.513	348.38.523	-
Tiomos Night - Anthracite finish			
0 mm	348.38.040	348.38.050	-
2 mm	348.38.042	348.38.052	-

Grass Tiomos inline mounting plate



Nickel-plated

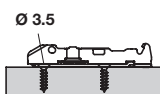

For Varianta



Anthracite



Nickel-plated

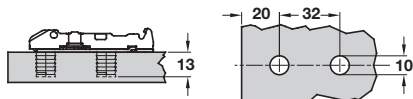

With dowel fixing

- > For TIOMOS click on fixing hinges only
- > Varianta screw fixing or dowel fixing
- > Two part plate with ± 2 mm height adjustment via worm screw
- > Steel
- > Order fixing screws separately for Varianta screw fixing versions
- > Order qty: 1 pc



Height	Screw fixing	Dowel
Nickel-plated finish		
0 mm	348.38.501	348.38.010
2 mm	348.38.502	348.38.012
3 mm	348.38.503	-
Tiomos Night - Anthracite finish		
0 mm	348.38.030	-
2 mm	348.38.032	-
3 mm	348.38.033	-



Order Varianta screw **013.01.711** separately for screw fixing version to ensure correct fit, shown in **Section 13** on page **22**



Most of the products you will find in this catalogue are available within 24 hours. However, to be able to offer the breadth of range in our collection, a small number of products have a longer lead time that is typically around 14 days. Please call 0800 171 2909 for an accurate delivery date when you see this symbol.

Grass Tiomos cruciform mounting plates, 2 point fixing

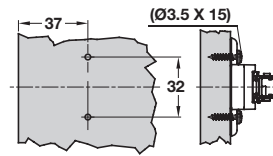
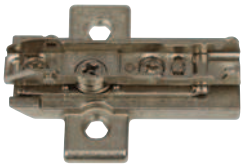

- > For TIOMOS click on fixing hinges only
- > Hospa screw fixing
- > Two part plate with ± 2 mm height adjustment via worm screw
- > Nickel-plated steel
- > Order fixing screws separately
- > Order qty: 1 pc



Height	Hospa screw
6 mm	348.39.511
8 mm	348.39.512
14 mm	348.39.536
19 mm	348.39.519
21 mm	348.39.520

Grass Tiomos inset beaded mounting plate for frame constructions, 3 point fixing

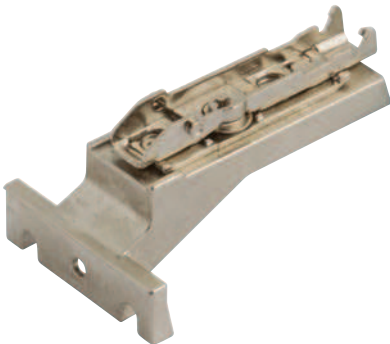

- > For inset doors
- > To be used with TIOMOS half overlay hinges
- > Hospa screw fixing
- > With convenient height adjustment ± 2 mm via worm screw
- > Nickel-plated steel and zinc alloy
- > Order fixing screws separately
- > Order qty: 1 pc

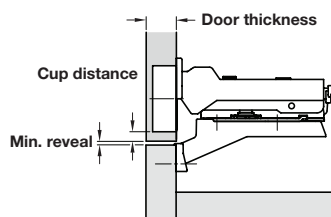
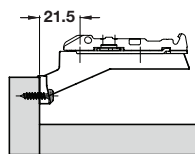
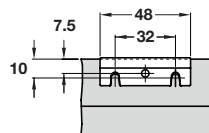

Door thickness mm								
	16	18	19	20	22	24	26	28
	3	3	3	3	3	3	3	3
	4	4	4	4	4	4	4	4
	5	5	5	5	5	5	5	5
	6	6	6	6	6	6	6	6
Distance to cup mm	Minimum reveal mm							
	4	3	2	1				



Height	Cat. No.
0 mm	348.38.020

Grass Tiomos ECON cruciform mounting plate, 3 point fixing

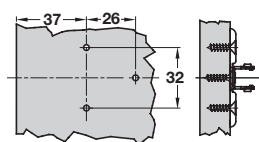

For Hospa screws

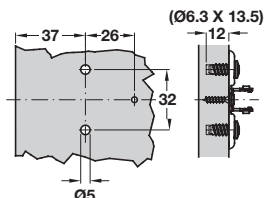

With pre-mounted Euro screws

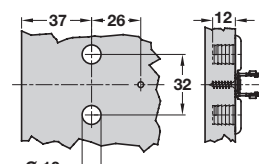

With dowel fixing

- > For TIOMOS click on fixing hinges only
- > Hospa screw fixing or with pre-mounted Euro screws or dowel fixing
- > One part plate with ± 2.5 mm height adjustment by slot
- > Nickel-plated steel
- > Order fixing screws separately for Hospa screw fixing versions
- > Order qty: 1 pc



Height	Hospa screw	Pre-mounted	Dowel
0 mm	348.38.612	348.38.551	348.38.591
2 mm	348.38.613	348.38.552	348.38.592
-2 mm	348.38.560	-	-



TIOMOS click on fixing hinges are shown on pages 36-63

Cover caps

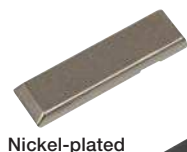

Nickel-plated

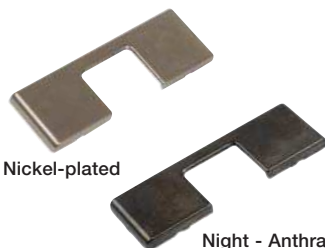
Night - Anthracite
For hinge arm

Nickel-plated

Night - Anthracite
For hinge cup

- > Steel
- > Order qty: 1 pc



Suitable for	Hinge arm	Hinge cup
Nickel-plated finish	348.40.000	348.40.001
Night - Anthracite finish	348.40.005	348.40.006

Grass Tiomos cover caps, with Grass logo



- > Suitable for hinge arm
- > With GRASS logo embossed
- > Nickel-plated steel
- > Order qty: 1 pc



Hand	Right	Left
Cat. No.	348.40.003	348.40.004

Grass Tiomos wedge



Wedge +5°

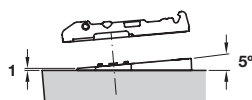

Wedge -5°

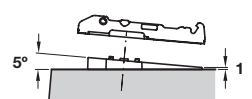

- > Ideal for curved door applications
- > For cruciform mounting plates that require underlaying either $\pm 5^\circ$
- > For screwing into 32/37 mm series drilled holes
- > Nickel plated zinc alloy
- > *Max. 3 wedges stacked on top of each other
- > Order qty: 1 pc



	Cat. No.
Wedge + 5° *	348.40.020
Wedge - 5°	348.40.021