

Flush hinge, straight 290, for inset doors

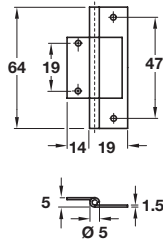

- > Light duty applications
- > With fixed brass pin
- > Non-mortice, unhandred
- > Extruded solid brass
- > Order fixing screws separately
- > Order qty: Multiples of 20 pcs



Finish	Cat. No.
Self colour	354.95.810

Flush hinge, for inset doors

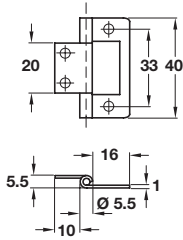
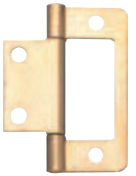

- > With fixed pin
- > Non mortice
- > Steel
- > Order fixing screws separately
- > Order qty: Multiples of 10 pcs



Finish	Cat. No.
Electro brassed	351.95.503
Zinc-plated	351.95.905

Flush hinge, for inset doors

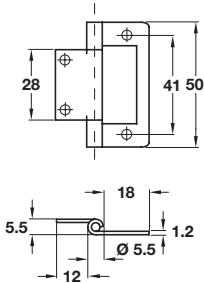
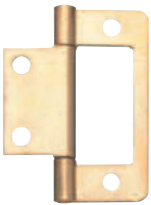

- > With fixed pin
- > Non mortice
- > Steel
- > Order fixing screws separately
- > Order qty: Multiples of 10 pcs



Finish	Cat. No.
Electro brassed	351.95.512
Zinc-plated	351.95.914
Florentine bronzed	351.95.110

Flush hinge, for inset doors

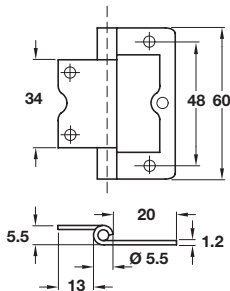

- > With fixed pin
- > Non mortice
- > Steel
- > Order fixing screws separately
- > Order qty: Multiples of 10 pcs



Finish	Cat. No.
Electro brassed	351.95.558
Zinc-plated	351.95.950
Florentine bronzed	351.95.156