

LATCH HOOK

LOAD CAPACITY
20 kg
44 lbs

4x25
STAINLESS

STAINLESS 316 STEEL

EN-R80



PAT.P

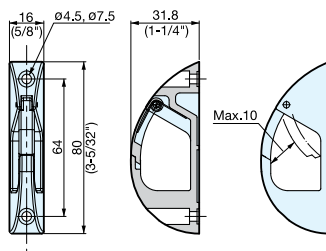

- Keeps items hooked, ideal for vibration or shock application.

Item No.	Load Capacity (kg)		Weight (g)	Box (pcs)	Carton (pcs)
	Hook	Arm			
EN-R80	20 (44 lbs)	10 (22 lbs)	85	10	120

Material	Finish
316 Stainless Steel	Polished

LATCH HOOK

NSF

3.5x16
STAINLESS

STAINLESS 304 STEEL

WH

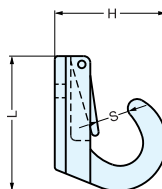
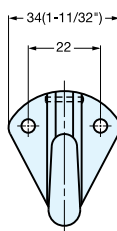

- Keep items hooked, ideal for vibration or shock applications.

Item No.	L	H	S	Weight (g)	Box (pcs)	Carton (pcs)
WH-1	37 (1-29/64")	25 (63/64")	5	40	20	200
WH-2	41 (1-39/64")	34 (1-11/32")	11	55		

Material	Finish
304 Stainless Steel	Satin

HOOK

TEST METHOD

LOAD CAPACITY
8-10 kg
17.6-22 lbs

4.1x16
STAINLESS

STAINLESS 304 STEEL

HJT

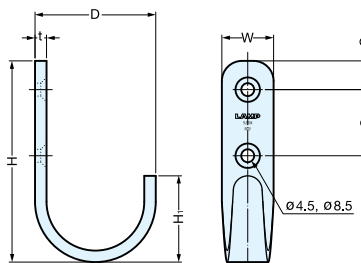

- 304 stainless steel hook.
- 4mm thick material used for excellent durability.

Item No.	D	H	H ₁	t	W	C ₁	C ₂	Load Capacity (kg)	Weight (g)	Box (pcs)	Carton (pcs)
HJT-55	33	55	23	4	15	8	19	10 (22 lbs)	34	30	300
HJT-70	42	70	30	4	18	10	23	8 (17.6 lbs)	53	20	200

Material	Finish
304 Stainless Steel	Satin

FORK HOOK

LOAD CAPACITY
20-30 kg
44-66 lbs

4.1x20
3.5x20
STAINLESS

STAINLESS 316 STEEL

EU



PAT

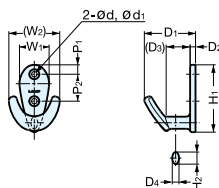

- Hook with unique design.
- Can hang 3 items at same time. Two on the tips and one on the neck.
- Two-tip shape ideal to hang hats, caps etc.

Item No.	W ₁	W ₂	D ₁	D ₂	D ₃	D ₄	H ₁	H ₂	d	d ₁	P ₁	P ₂
EU-50	22	38 (1-1/2")	38 (1-1/2")	4	17.8	5	50 (1-31/32")	9	4	7.4	7	20
EU-72	32	56 (12-13/64")	52 (2-3/64")	6	23	8	72 (2-53/64")	14	4.6	8.6	10	34

Item No.	Load Capacity (kg)	Weight (g)	Box (pcs)	Carton (pcs)
EU-50	20 (44 lbs)	42	20	120
EU-72	30 (66 lbs)	118	10	60

Material	Finish
316 Stainless Steel	Mirror