

FLUSH SLAM LATCH



LC-65A



PAT.P

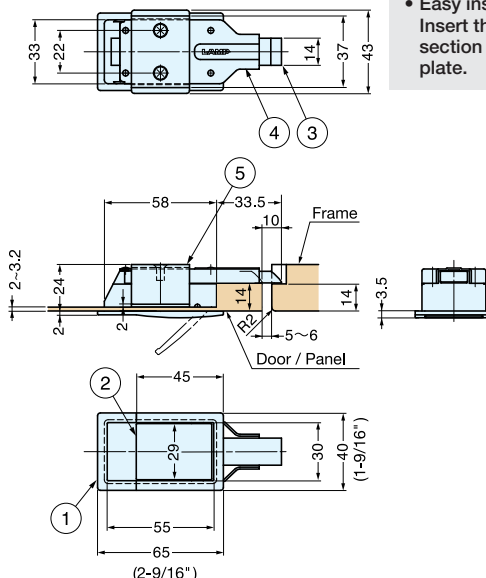

- Door will be latched when closed.
- Pull paddle handle to open.
- Non-handed.
- Designed for panel thickness 2.0~3.2 mm.
- Easy installation.
Insert the latch body through cutout section and simply screw-on the back plate.

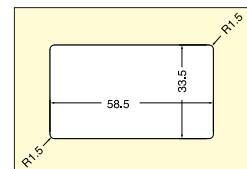

Cut Out Dimensions

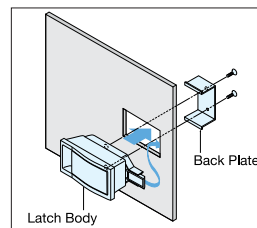

No.	Part Name	Material	Finish
①	Body	Aluminum Alloy	Silver
②	Lever		
③	Latch Bolt	Polyacetal	White
④	Back Cover	304 Stainless Steel	Plain
⑤	Back Plate		

Item No.	Door Thickness	Weight (g)	Box (pcs)	Carton (pcs)
LC-65A	2.0 ~ 3.2	108	10	100

FLUSH SLAM LATCH



LJ-61



PAT.P

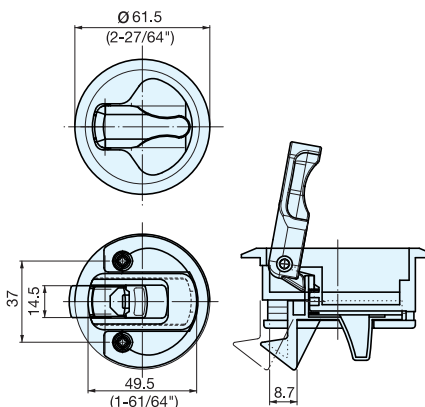

- Door will be latched when closed.
- Pull lever to open.
- Non-handed.
- All components are plastic, 304 or 316 stainless steel to provide high corrosion resistance.
- Easy installation.
Insert the latch body through single round cutout or bore section and screw-on the back plate. Back plate is designed to accommodate door thickness 0.8mm ~ 12mm, and also 12.5mm ~ 22mm by flipping over the back plate.

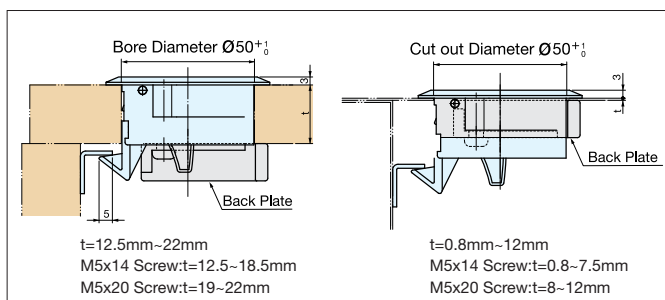

Installation

Item No.	Weight (g)	Box (pcs)	Carton (pcs)	Part Name	Material	Finish / Color
LJ-61/BLK	450	10	120	Body/Spring	Polyacetal, Polycarbonate, 316 Stainless Steel	Black, White
LJ-61/WHT	450	10	120	Counterplate	316 Stainless Steel	Satin