

Hinge systems

blum

- ▶ **MODUL – hinges**
- ▶▶ **Refrigerator application**



Refrigerator facade door hinge

Webcode
DQE5BY



- Hinge for refrigerator facade doors
- Shallow hinge arm height
- **MODUL** with closing mechanism (spring)
- Slide on hinge arm
- Can only be combined with mounting plate 194K6100E
- All metal hinge, nickel plated
- 95° opening angle
- 3-dimensional front adjustment possible when attached to refrigerator
- Assembly and removal of front possible when refrigerator is installed

Application

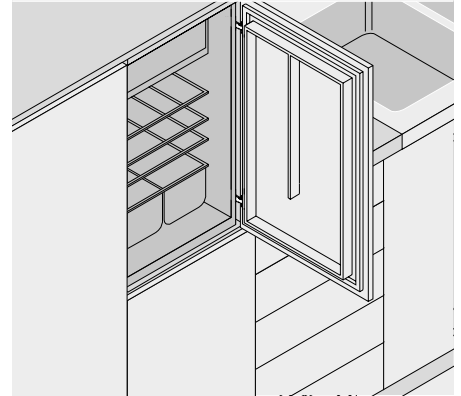

Order information

Overlay application

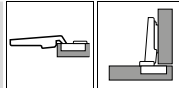

<input type="checkbox"/> Boss	<input type="checkbox"/> Screw-on	
Hinge	Spring	Part no.
MODUL	●	91K9550
● With spring	○ Unsprung	

<input type="checkbox"/> Boss	<input type="checkbox"/> Knock-in	
Hinge	Spring	Part no.
MODUL	●	91K9580

<input type="checkbox"/> Cruciform mounting plate for refrigerator facade door hinge		
Spacing (mm)	Height (mm)	Part no.
0	10.3	194K6100E

a Accessories – general

<input type="checkbox"/> Hinge boss cover cap		
Hinge		Part no.
MODUL		70T3504

<input type="checkbox"/> Insertion ram		
Material	Colour	Part no.
Nylon	Orange	MZM.0040

<input type="checkbox"/> Chipboard screws		
Ø (mm)	Length (mm)	Part no.
3.5	15	609.1500
3.5	17	609.1700

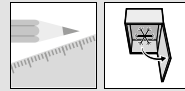

Refrigerator facade door hinge

Webcode
DQE5BY

Planning

Hinge dimensions and gap calculation based on factory setting (mounting plate spacing = 0 mm)

Hinge and front protrusion at full opening angle

Overlay application

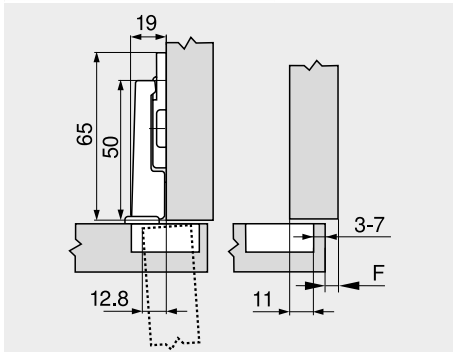
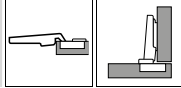

F Gap

Drilling distance TB

MD	Front overlay FA (mm)																	
	6	7	8	9	10	11	12	13	14	15	16	17	18					
0										3	4	5	6	7				
3																		
6																		
9																		

MD Mounting plate spacing (mm)

Minimum gap (F) for fronts with a front radius (R = 1 mm) based on the factory setting

Drilling distance TB (mm)	Front thickness FD (mm)											
	16	18	19	20	22	24	26	28	29	30	31	32
3	0.2	0.2	0.3	0.4	0.5	0.8	1.3	2.5	3.5	4.4	5.3	6.1
4	0.2	0.2	0.3	0.4	0.5	0.8	1.3	1.9	2.9	3.8	4.7	5.5
5	0.2	0.2	0.3	0.4	0.5	0.8	1.2	1.7	2.4	3.2	4.0	4.9
6	0.2	0.2	0.3	0.4	0.5	0.8	1.2	1.7	2.2	2.8	3.5	4.3
7	0.2	0.2	0.3	0.4	0.5	0.8	1.2	1.6	2.0	2.4	3.0	3.8
Additional for +2 mm side adjustment												
	+0.0	+0.1	+0.1	+0.1	+0.3	+0.5	+0.4	+0.4	+0.4	+0.4	+0.3	+0.2



Adjustment

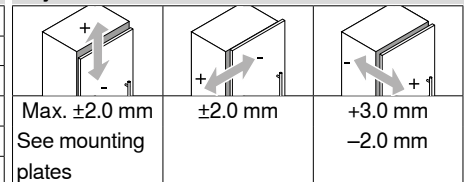

Screw-on

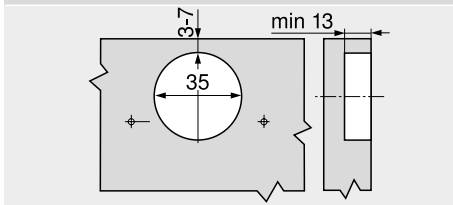

Knock-in

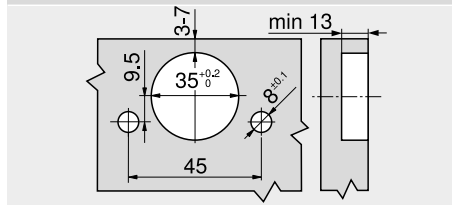

Hinge boss dimensions

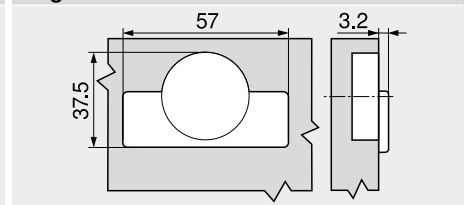

Page instructions

Overview – MODUL – hinges	199
Mounting plates	206
Accessories – general	210
Assembly, removal and adjustment	212
Overview – assembly devices	683
More technical details	774