

Aluminium Hinge - Ref. 2841

Suitable for medium weight toilet cubicle and internal flush doors



Product features

- rise or fall of 13 mm at 180°
- galvanised steel pin
- 10 year performance guarantee
- suitable for medium weight toilet cubicle and internal flush doors
- fitted with medium-duty galvanised steel skews
- radius corners optional, by special request
- handed left or right

Technical data

Property	Value
Load capacity	25.0 kg
Knuckle Diameter	14.5 mm
Overall length	100.0 mm
Overall width	68.0 mm
Material thickness	4.0 mm
Screw	10.0 x 32.0 mm

Notes

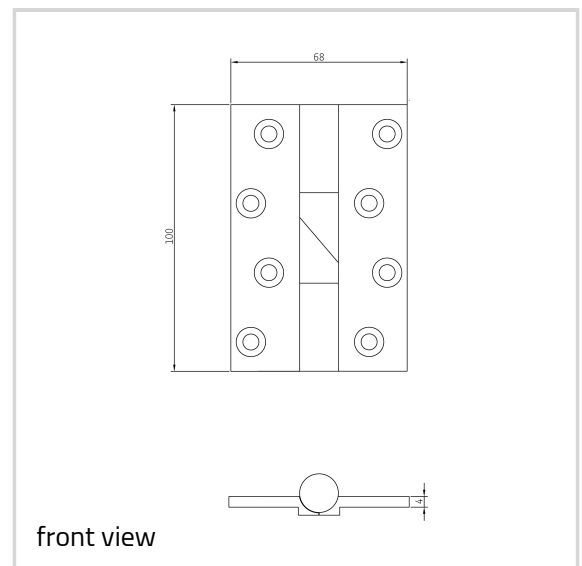

Brass Hinges - Aluminium Hinge - Ref. 2841

Other anodised finishes available on request.

Supplied complete with pozi/slotted head brass woodscrew if required.

Item versions

Finish	without (000)
OF-No.	000
VPE	10 pcs
DIN	DIN right and left hand
Article number	2841